

SUPPORT BUILDING PARTIAL FLOOR PLAN

SCALE: 1/16" = 1'-0" 58,591 SF TOTAL

KITCHEN NOTES

1. ADD 31" WIDE BAY TO ALLOW RELOCATION OF OFFICER AND INMATE DINING AND BAKERY TO CREATE MORE SPACE IN KITCHEN FOR FOOD CART STAGING AND STORAGE.
2. EXPANDED CART STAGING AND STORAGE, DISH WASHING, CART SANITIZING, FOOD PREPARATION AND REFRIGERATION IN SPACE VACATED BY RELOCATING OFFICER AND INMATE DINING AND BAKERY.
3. ADDITIONAL SPACE FOR CART STAGING AND STORAGE.
4. EXTEND EXHAUST HOODS.
5. 2 ADDITIONAL STOVES.
6. 2 ADDITIONAL GRIDDLES.
7. 2 ADDITIONAL STEAM KETTLES.
8. ADDITIONAL ROTATING RACK OVEN.
9. ADDITIONAL PROOFING CABINET.
10. ADDITIONAL DRY STORAGE IN SPACE CREATED BY RELOCATING CART STORAGE EAST.
11. ADD NEW COMPACTOR IN PREVIOUSLY ALLOCATED SPACE WITH EXISTING UTILITIES.

GENERAL NOTES

- A. ADD VIDEO ARRANGMENT EQUIPMENT IN EXISTING COURT ROOM.
- B. ADD SPACE FOR 2 SUPERVISOR REPORT ROOMS AND 2 INMATE CLASSIFICATION OFFICES.
- C. ADD SPACE FOR ADDITIONAL PROPERTY STORAGE.
- D. ADD SPACE FOR RELOCATED WATCH COMMANDER AND SERGEANT REPORT ROOM.
- E. MODIFY RELOCATED REPORT ROOM FOR LEISURE LIBRARY.
- F. REMODEL X-RAY ROOM AND WATCH COMMANDERS OFFICE FOR NEW MEDICAL WARD. X-RAY TO BE BY PORTABLE MACHINE IN EXAM ROOMS.
- G. SPLIT LEGAL LIBRARY INTO COMPUTER LEGAL LIBRARY AND RELIGIOUS SPACE.
- H. REMODELED AREA FOR SINGLE HOLDING CELLS.
- J. RELEASE AREA TO BE ACTIVATED.
- K. INTEGRATE CONTROLS FOR ADDITION INTO TOUCH SCREEN - INTEGRATE INTERCOM WITH DOOR CONTROL AND CCTV.

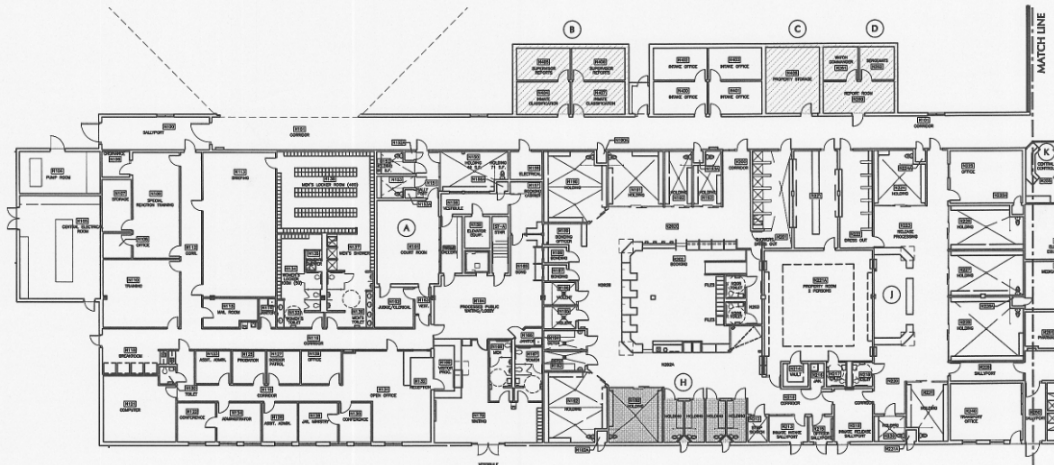

SUPPORT BUILDING PARTIAL FLOOR PLAN

SCALE: 1/16" = 1'-0" 58,591 SF TOTAL

LEGEND	
	RENOVATED AREA
	ADDITION